

ITEM NO.	Q.TY	PART NAME	MATERIAL (LF2/316)	MATERIAL (316/316)	OPTIONS AVAILABLE
NP	1	Name Plate	AISI 316	AISI 316	
1	1	Handle	Carbon Steel + Epoxy Coated	Carbon Steel + Epoxy Coated	AISI 316
2a	2	Handle nut	AISI 304	AISI 304	AISI 316
2b					
3	1	Packing ring	Graphite	Graphite	Virgin/Reinforced PTFE
4	2	Spring washers	AISI 316 Treated	AISI 316 Treated	
5	1	Antistatic stem	AISI 316/316L Dual Certified	AISI 316/316L Dual Certified	Special materials
6	****	Gland packing	AISI 316	AISI 316	
7	1	Thrust washer	PTFE	PTFE	Reinforced PTFE – PEEK
8	1	“O”ring stem	Viton	Viton	See seat and seal material table
9	1	Ball	AISI 316/316L Dual Certified	AISI 316/316L Dual Certified	Special materials
10	2	Seats	“S”	“S”	See seat and seal material table
11	2	I° Body seals	“S”	“S”	See seat and seal material table
12	1	Body	LF2	AISI 316/316L Dual Certified	Special materials
13	2	End connections	LF2	AISI 316/316L Dual Certified	Special materials
14	1	Stop-pin	AISI 316	AISI 316	
16	8	Bolts	L7 + Zinc Plated	B8	Special materials
17	1	Stop washer	AISI 304	AISI 304	AISI 316
18	2	II° Body seals	Graphite	Graphite	Virgin PTFE
ENCAPSULATED SEAT OPTION					
20	2	Seats	“S”	“S”	See seat and seal material table
21	2	Seat Seal	Viton	Viton	See seat and seal material table
22	2	Ring Seat	LF2	AISI 316/316L Dual Certified	Special materials
23	2	Ring Seal	Viton	Viton	See seat and seal material table

RECOMMENDED SPARE PARTS FOR START-UP OR COMMISSIONING

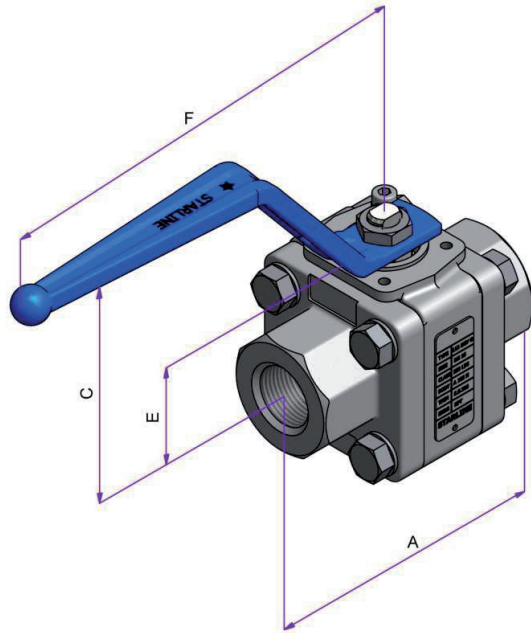

NPT-BSPP-BSPT

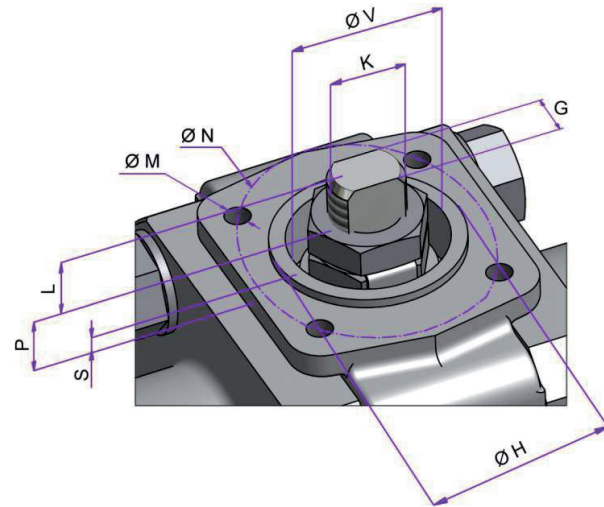

**TOP
VIEW**

FULL BORE							
VALVE SIZE		DIMENSIONS [mm]					WEIGHT [Kg]
NPS	DN	A	BORE	C	E	F	NPT - BSPP - BSPT
		NPT - BSPP - BSPT					
1/4" x 1/4"	08 x 08	75	11.1	79	30.5	144	1
3/8" x 3/8"	10 x 10	75	11.1	79	30.5	144	1
1/2" x 1/2"	15 x 15	80	14.2	81	32.5	144	1.2
3/4" x 3/4"	20 x 20	100	20.5	98	39	172.5	2.3
1" x 1"	25 x 25	110	25.4	100	38	172.5	3.2
1.1/4" x 1.1/4"	32 x 32	120	31.7	110	43.5	218	4.5
1.1/2" x 1.1/2"	40 x 40	140	38	112	47.5	218	5.3

TOP MOUNTING											
VALVE SIZE		DIMENSIONS [mm]									ISO 5211
NPS	DN	L	P	S	V	K	G	H	N	M	
1/4" x 1/4"	08 x 08	3.6	5.4	1.5	21	M10x1	5.5	25	36	M5x8	F03
3/8" x 3/8"	10 x 10	3.6	5.4	1.5	21	M10x1	5.5	25	36	M5x8	F03
1/2" x 1/2"	15 x 15	3.6	5.9	1.5	21	M10x1	5.5	25	36	M5x8	F03
3/4" x 3/4"	20 x 20	9	5	1.5	25	M12x1.25	7.5	30	42	M5x8	F04
1" x 1"	25 x 25	10	10	1.5	25	M12x1.25	7.5	30	42	M5x8	F04
1.1/4" x 1.1/4"	32 x 32	13	14	1.5	30	M15x1.5	8.9	35	50	M6x10	F05
1.1/2" x 1.1/2"	40 x 40	14	14	1.5	30	M15x1.5	8.9	35	50	M6x10	F05

Dimensions and weights are subject to change without notice.
Face to face dimensions not listed in industry standards are subject to change without notice.