

Description

Header tank for application where a hydraulic control station is located on a lower level than a quick closing valve.

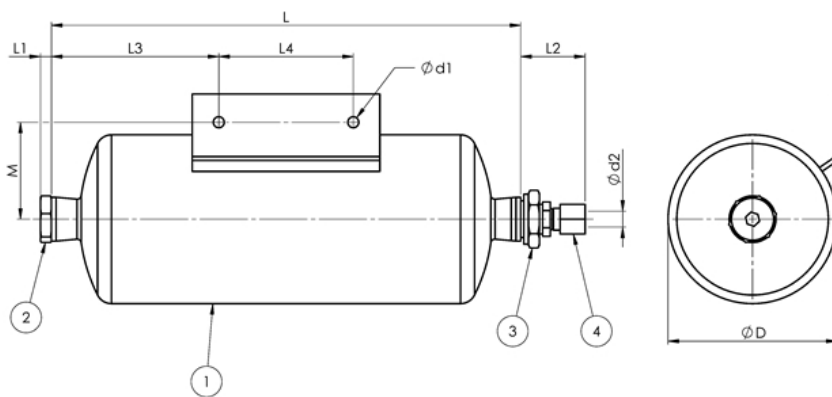

Header tank



Header tank

Material

No.	Part	Material
1	Housing	Stainless steel 1.4301 (AISI304)
2	Plug	Brass CW607N (Ms58)
3	Coupling	Galvanized steel
4		Galvanized steel



Header tank

Item no.	L	D	d1	d2	L1	L2	L3	L4	M	Weight (kg)	Type
96323	300	108	7		7	40	107	86	62	2.8	2 liter volume, 6mm coupling.
96174	300	108	7	8	7	40	107	86	62	2.8	2 liter volume, 8mm coupling.

All measurements in mm. Weights are approximations.

CONNECTION KIT

Item no.	Weight (kg)	Type
96324	0.26	Connection kit for header tank for connecting 1 gc handle to header tank for 6 mm pipe
96029	1.0	Connection kit for header tank for connecting 1 gc handle to header tank for 8 mm pipe

All measurements in mm. Weights are approximations.

