

Description

Ball valve is mainly used as shut off in liquid systems where it is a need for high flow. Quarterturn operation. Full bore. Top flange according to ISO 5211. Design according to EN 12516. Anti-static stem.

Specifications

Flange standard:	EN 1092-1
Execution:	Straight
Connection type:	Flanged
Operation:	Lever
Actuation:	Quarterturn



Media

Fuel oil, lubricating oil and flammable hydraulic oil. Cargo oil. Air. Gas.
Non-flammable hydraulic fluid. Boiler feedwater, condensate.
Seawater and freshwater.

Material

No.	Part	Material
1	Body	Stainless steel 1.4408 (AISI316)
2	Ball (relief hole)	Stainless steel 1.4401 (AISI316)
3	Seat	PTFE
4	Cap	Stainless steel 1.4408 (AISI316)
5	Stem	Stainless steel 1.4401 (AISI316)
6	Stem packing	PTFE
7	Handle	Stainless steel 1.4301 (AISI304)

Max. working pressure (bar) at °C

DN	Connection	38°C	100°C	150°C	180°C
15 - 100	PN 16	16	10	5	2

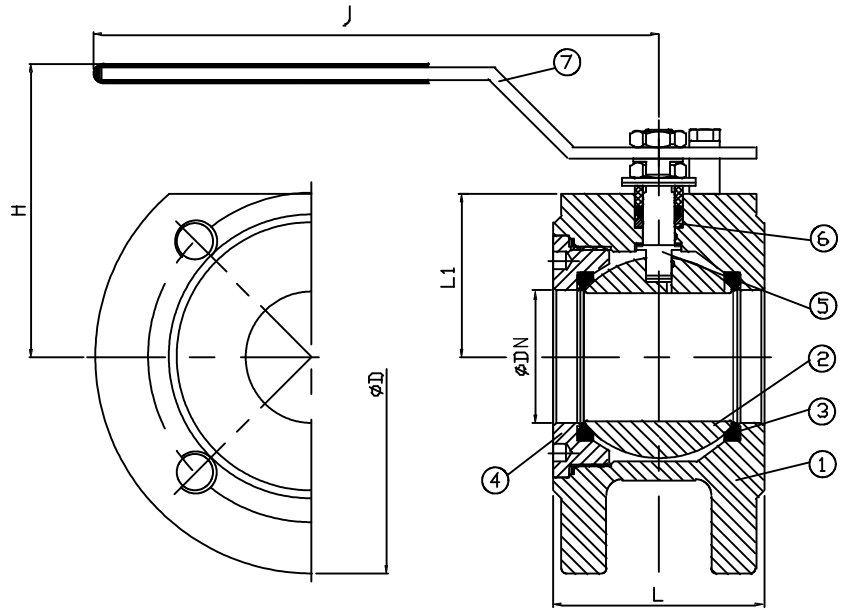

Items

DN	Item no.	Pressure rating	Connection	L	D	L1	H	J	ISO 5211	Weight (kg)
15	41305	PN 40	PN 40	35	95	30.5	76	151	F03	0.98
20	41306	PN 40	PN 40	38	105	35.5	85	151	F03	1.36
25	81055	PN 40	PN 40	44	115	41	93	154	F04	1.90
32	91508	PN 40	PN 40	54	140	46.5	100	173	F05	2.96
40	90715	PN 40	PN 40	62	150	56	112	216	F05	3.78
50	81606	PN 40	PN 40	80	165	63.5	120	216	F05	6.89
65	41307	PN 40	PN 40	104	185	84.5	148	262	F07	11.1
80	41308	PN 40	PN 40	118	200	90.6	150	262	F07	13.9
100	41309	PN 16	PN 16	150	220	108	182	500	F07	22.7

All measurements in mm. Weights are approximations.

