

Description

Wafer type swing check valve, for installation between flanges
PN10/PN16.

Specifications Operation: Automatic

Media

Steam. Thermal oil. Fuel oil, lubricating oil and flammable hydraulic oil.
Cargo oil. Air. Gas. Non-flammable hydraulic fluid. Boiler feedwater,
condensate. Seawater and freshwater.

Variants

O-ring material EPDM (-40°C to +120°C), PTFE (-50°C to +220°C) or FPM/FKM (-30°C to +180°C). Larger dimensions on request.



Material

No.	Part	Material
1	Body	Stainless steel 1.4408 (AISI316)
2	Disc	Stainless steel 1.4408 (AISI316)
3	Bolt	Stainless steel 1.4401 (AISI316)
4	Eye bolt	8.8 FZB
5	O-ring	NBR
6	O-ring	NBR

Max. working pressure (bar) at °C

DN	Connection	-40°C to +95°C
50 - 200	PN 16	16
250 - 300	PN 10	10

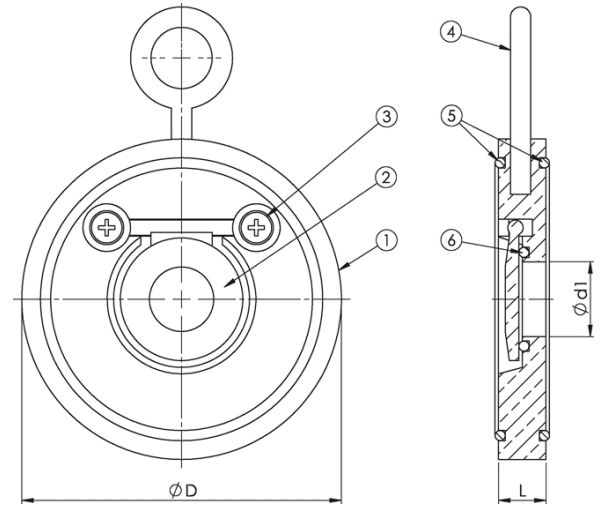

Items

DN	Item no.	Pressure rating	Connection	L	D	d1	Weight (kg)
50	81790	PN 16	PN 16	14	109	32	0.9
65	90069	PN 16	PN 16	14	128	40	1.2
80	81814	PN 16	PN 16	14	145	54	1.5
100	90071	PN 16	PN 16	18	164	70	2.5
125	90072	PN 16	PN 16	18	195	92	3.3
150	81791	PN 16	PN 16	20	221	112	4.7
200	90074	PN 16	PN 16	22	275	154	7.8
250	89452	PN 10	PN 10	26	330	200	13.0
300	91996	PN 10	PN 10	32	380	240	19.0

All measurements in mm. Weights are approximations.

