

## RUBBER EXPANSION JOINTS WITH TIE BARS

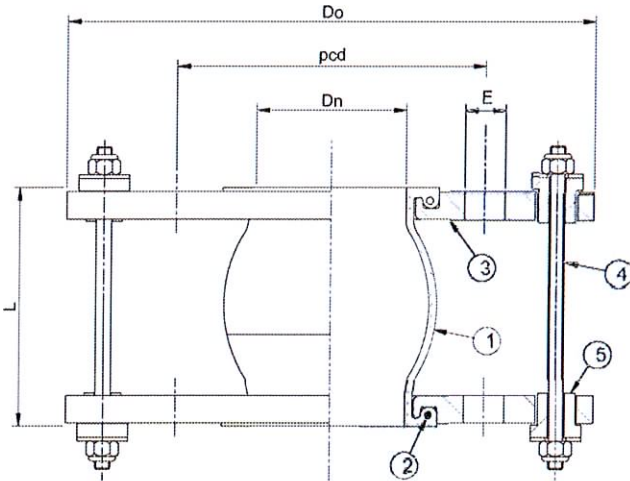

### STRUCTURE

Item#	Part	Materials
1	Body	EPDM Rubber, Nylon Tyre Cord Reinforced
2	Wire	Hard Steel Wire
3	Flange	Mild Steel Zinc Plated
4	Tie Rod	Galvanized with Locking Nuts
5	Top Hat	EPDM Rubber Top Hat Washer

Dn mm	Do mm	L mm	pcd mm	E mm	No Holes "X"	Axial Compression - mm	Max. Pressure Barg - 20°C	Max. Temp. °C	Max. Vacuum Bar
40	245	130	110	18	4	30	16	100	0.5
50	260	130	125	18	4	30	16	100	0.5
65	280	130	145	18	4	30	16	100	0.5
80	295	130	160	18	8	30	16	100	0.5
100	315	130	180	18	8	30	16	100	0.5
125	345	130	210	18	8	30	16	100	0.5
150	400	130	240	22	8	30	16	100	0.5
200 (Pn10)	455	130	295	22	8	30	16	100	0.5
200 (Pn16)	455	130	295	22	12	30	16	100	0.5
250 (Pn10)	395*	130	350	22	12	30	10	100	0.5
250 (Pn16)	405*	130	355	26	12	30	10	100	0.5
300 (Pn10)	445*	130	400	22	12	30	10	100	0.5
300 (Pn16)	460*	130	410	26	12	30	10	100	0.5

\* Executed with square flanges and 4 tie rods

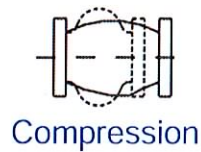
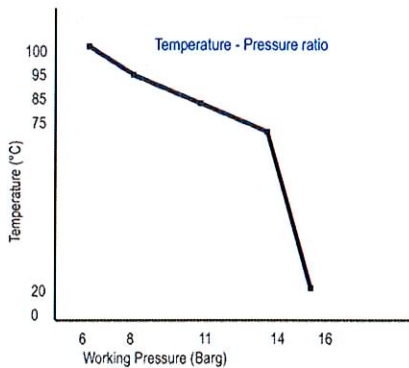

### Remarks:

1. Applicable fluids: water, warm water, seawater, weak acids, alkalies etc...
2. Available flange drilling: DIN Pn 10 / 16