



# Mud box 482151

## DESCRIPTION

Mud box, angle with PN 10 drilled flange ends.

Face to face according to DIN 87151.

Mesh-size:

- DN 40-65 5x5mm
- DN 80-300 8x8 mm

## VARIANTS

Other strainer materials and mesh-sizes.



No.	Part	Material
1	Body	Cast iron EN-JL1040 (GG25)
2	Washer	(DN 80-150) Copper
3	Plug G1/2"	(DN 80-150) Brass CW614N (Ms 58)
4	Strainer elemnet	Stainless steel 1.4432 (AISI 316L)
5	O-ring	NBR
6	Bonnet	Cast iron EN-JL1040 (GG25)
7	Flange nut	8.8 FZB
8	Stud bolt	8.8 FZB
9	Lifting eye bolt	8.8 FZB

DN	Max. working pressure (bar)
	up to 80°C
40-300	4

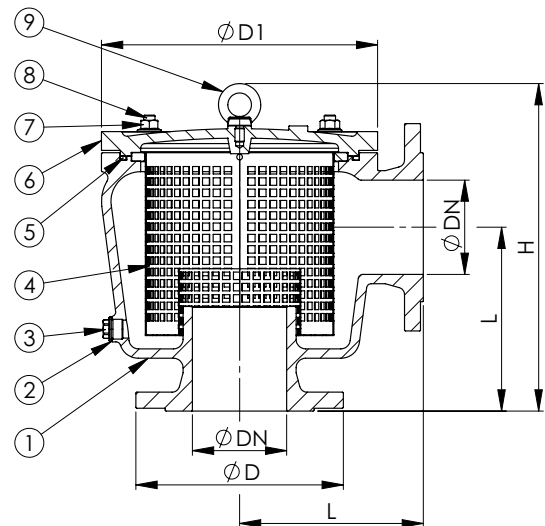

DN	Connection	Pressure rating	L	D	D1	H	Height for lifting strainer element	Kg
40	PN 10	PN 4	125	150	160	228	272	13
50	PN 10	PN 4	135	165	197	244	300	18
65	PN 10	PN 4	150	185	215	268	343	22
80	PN 10	PN 4	175	200	255	301	406	30
100	PN 10	PN 4	198	220	293	347	470	42
125	PN 10	PN 4	220	250	340	387	543	56
150	PN 10	PN 4	270	285	430	471	661	91
200	PN 10	PN 4	300	340	505	531	771	133
250	PN 10	PN 4	390	395	505	646	996	166
300	PN 10	PN 4	450	445	620	736	1168	252

All measurements in mm. Flanges according to ISO 7005. Weights are approximations.



# Mud box DN 350-600 482151

## DESCRIPTION

Mud box, angle with PN 10 drilled flange ends.  
Face to face according to DIN 87151.  
Mesh-size 8x8 mm.

## VARIANTS

Other strainer materials.



No.	Part	Material
1	Body	Cast iron EN-JL1040 (GG25)
2	Washer	(DN 80-150) Copper
3	Plug G1/2"	(DN 80-150) Brass CW614N (Ms 58)
4	Strainer element	Stainless steel 1.4401 (AISI 316)
5	O-ring	NBR
6	Bonnet	Cast iron EN-JL1040 (GG25)
7	Flange nut	Steel
8	Stud bolt	Steel
9	Lifting eye bolt	Steel

DN	Max. working pressure (bar)
	up to 80°C
350-450	4
500-600	2,5

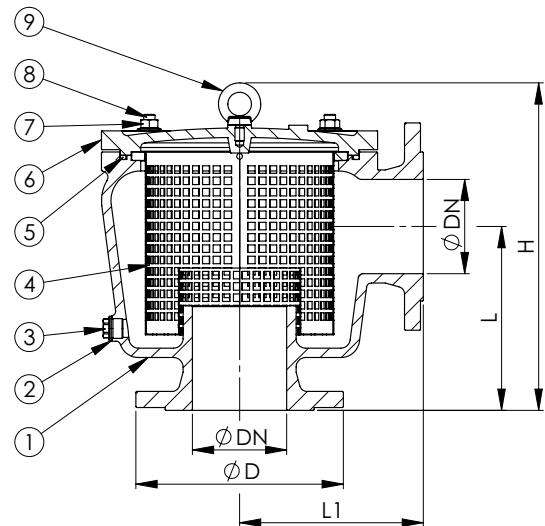

DN	Connection	Pressure rating	L	L1	D	H	Kg
350	PN 10	PN 4	400	400	505	735	230
400	PN 10	PN 4	420	520	565	950	320
450	PN 10	PN 4	625	625	615	1050	460
500	PN 10	PN 2,5	550	550	670	1070	700
600	PN 10	PN 2,5	620	720	780	1225	950

All measurements in mm. Flanges according to EN 1092/B. Weights are approximations.



# Strainer for mud box

## DESCRIPTION

Material: Stainless steel 1.4432 (AISI 316L)  
 For mud box 482051 and 482151. Mesh-size: DN 40-65, 5x5 mm, DN 80-500, 8x8 mm.

## VARIANTS

Other mesh-size.

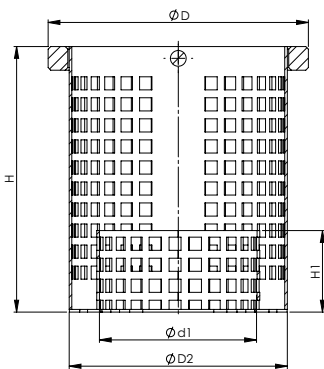

485021 (straight)

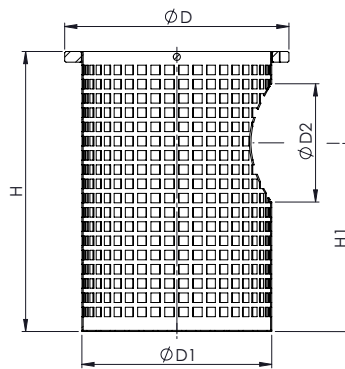

485121 (angle)

DN	D	D1	D2	H	H1
40	75	59	40	120	80
50	99	83	50	136	87
65	134	107	65	170	112,5
80	151	122	80	200	134
100	189	160	100	236	159
125	229	200	125	290	198,5
150	270	240	150	340	236
200	342	311	200	428,5	291,5
250	420	389	250	520,5	358,5
300	420	389	300	635,5	448,5

All measurements in mm. Weights are approximations.

DN	D	D2	d1	H	H1
40	99	83	58	101	30
50	134	107	68	114	40
65	151	122	85	134	50
80	189	160	102	164	60
100	229	200	126	194	70
125	270	240	151	229	80
150	342	311	176	278,5	90
200	420	389	230	332	100
250	420	389	280	442	110
300	526	485	334	527	120

All measurements in mm. Weights are approximations.

Revision 1