



# Mudbox straight type 482051

## Description

Mudboxes are used in systems which needs to be protected against debris during pipe installation or regular operation. It is possible to get the strainer basket with different mesh size. Straight with PN 10 drilled flange ends. DN 200-300 with support feet. DN 350 available with other face to face dimensions.

## Specifications

Flange standard:	ISO 7005-2
Face to face standard:	DIN 87151-1
Bonnet connection:	Bolted
Execution:	Straight
Connection type:	Flanged
Perforation:	DN 40-65 5 x 5 mm, DN 80-600 8 x 8 mm

## Media

Fuel oil, lubricating oil and flammable hydraulic oil. Cargo oil. Seawater and freshwater.

## Variants

Other materials and mesh sizes on request.

## Material

No.	Part	Dimension	Material
1	Body		Cast iron EN-JL1040 (GG25)
2	Strainer	DN 40-300	Stainless steel 1.4432 (AISI316L)
2	Strainer	DN 350-600	Stainless steel 1.4401 (AISI316)
3	Pin	DN 40-300	Stainless steel 1.4432 (AISI316L)
3	Pin	DN 350-600	Stainless steel 1.4401 (AISI316)
4	O-ring		NBR
5	Bonnet		Cast iron EN-JL1040 (GG25)
6	Flange nut		8.8 FZB
7	Stud bolt		8.8 FZB
8	Lifting eyebolt		8.8 FZB



Mudbox without support feet



Mudbox DN 200-300 with support feet

Mudbox DN 200-300 with support feet



## Material

No.	Part	Dimension	Material
9	Washer	DN 80-600	Copper
10	Plug	DN 80-600	Brass CW614N (Ms58)

## Max. working pressure (bar) at °C

DN	Connection	up to 80°C
40 - 450	PN 10	4
500 - 600	PN 10	2.5

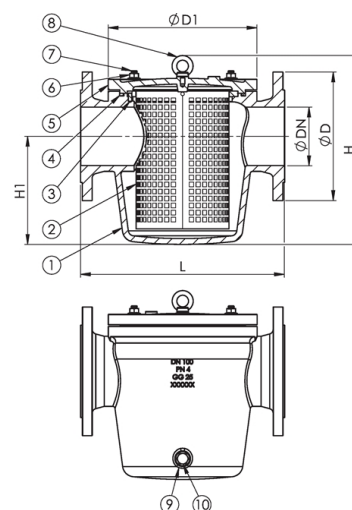

## Mudbox without support feet

DN	Pressure rating	Connection	L	D	D1	H	H1	Height for lifting strainer basket	Kv	Weight (kg)	Color	Item no.
40	PN 4	PN 10	200	150	130	191	95	255	42	9.1	Green RAL 6002	60517
50	PN 4	PN 10	230	165	160	214	106	291	64	14.0	Green RAL 6002	60518
65	PN 4	PN 10	290	185	197	252	134	362	104	21.0	Green RAL 6002	60519
80	PN 4	PN 10	310	200	215	282	156	421	160	25.0	Green RAL 6002	60520
100	PN 4	PN 10	350	220	255	323	185	498	240	37.0	Green RAL 6002	60521
125	PN 4	PN 10	400	250	293	394	229	683	360	51.0	Green RAL 6002	60522
150	PN 4	PN 10	480	285	340	447	268	712	520	68.0	Green RAL 6002	60523
350	PN 4	PN 10	610	505	503	750	390	1395	5794	300.0	Green RAL 6002	80844
400	PN 4	PN 10	740	565	580	900	475	1703	6962	305.0	Green RAL 6002	80142

All measurements in mm. Weights are approximations.



## Mudbox without support feet

DN	Pressure rating	Connection	L	D	D1	H	H1	Height for lifting strainer basket	Kv	Weight (kg)	Color	Item no.
450	PN 4	PN 10	1000	615	790	985	525	1865	8203	480.0	Green RAL 6002	80143
500	PN 2.5	PN 10	1100	670	922	1100	575	2096	9513	555.0	Green RAL 6002	40767
600	PN 2.5	PN 10	1100	780	922	1100	575	2106	12959	820.0	Green RAL 6002	40768

All measurements in mm. Weights are approximations.

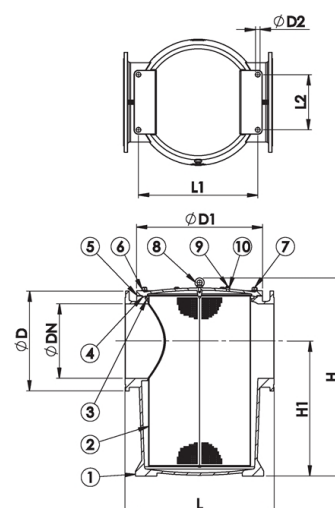

Mudbox DN 200-300 with support feet

## Mudbox DN 200-400 with support feet

DN	Pressure rating	Connection	L	D	D1	D2	L1	L2	H	H1	Height for lifting strainer basket	Kv	Weight (kg)	Color	Item no.
200	PN 4	PN 10	600	340	430	26	410	180	563	335	901	960	125.0	Green RAL 6002	60524
250	PN 4	PN 10	600	395	505	26	480	215	609	353	984	1530	165.0	Green RAL 6002	60525
300	PN 4	PN 10	600	445	505	26	480	215	664	383	1091	2170	178.0	Green RAL 6002	60526
400	PN 4	PN 10	740	565	620	32	580	260	965	629	1103	3700	328.0	Green RAL 6002	60528

All measurements in mm. Weights are approximations.