



Globe valve 467002

3

DESCRIPTION

Face to face dimensions according to EN 558, series 1.
Flanges according to PN 16, drilled (DN 200-500 PN 10).

APPLICATION

Liquids, steam and gases that do not attack the integral material.

VARIANTS

SDNR disc, regulating disc, stainless steel trim.



| No. | Part | Material |
|-----|---------------|---|
| 1 | Body | Nodular cast iron EN-JS1030 (GGG40) |
| 2 | Seat | Bronze CC491K (RG5) |
| 3 | Disc | (DN15-65) Bronze CC491K (RG5) (DN80-250) Nodular cast iron EN-JS1030 (GGG40) |
| 4 | Gasket | Graphite |
| 5 | Gland packing | Graphite |
| 6 | Bonnet | Nodular cast iron EN-JS1030 (GGG40) |
| 7 | Stem | Special brass CW710R (SoMs59) |
| 8 | Handwheel | Cast iron EN-JL1040 (GG25) |

| DN | Max. working pressure (bar) | |
|---------|-----------------------------|-------|
| | up to 120°C | 180°C |
| 15-150 | 16 | 10 |
| 200-250 | 10 | 6 |

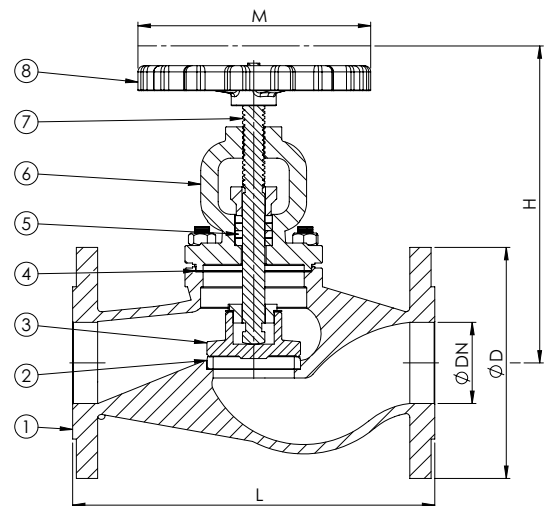

| DN | Connection | Pressure rating | L | D | H | M | Kg |
|-----|------------|-----------------|-----|-----|-----|-----|-----|
| 15 | PN 16 | PN 16 | 130 | 95 | 177 | 120 | 3,5 |
| 20 | PN 16 | PN 16 | 150 | 105 | 179 | 120 | 4 |
| 25 | PN 16 | PN 16 | 160 | 115 | 198 | 120 | 5 |
| 32 | PN 16 | PN 16 | 180 | 140 | 198 | 120 | 6,8 |
| 40 | PN 16 | PN 16 | 200 | 150 | 221 | 140 | 9,3 |
| 50 | PN 16 | PN 16 | 230 | 165 | 224 | 140 | 12 |
| 65 | PN 16 | PN 16 | 290 | 185 | 267 | 140 | 18 |
| 80 | PN 16 | PN 16 | 310 | 200 | 292 | 160 | 25 |
| 100 | PN 16 | PN 16 | 350 | 220 | 325 | 160 | 35 |
| 125 | PN 16 | PN 16 | 400 | 250 | 370 | 200 | 55 |
| 150 | PN 16 | PN 16 | 480 | 285 | 420 | 200 | 77 |
| 200 | PN 10 | PN 10 | 600 | 340 | 643 | 400 | 145 |
| 250 | PN 10 | PN 10 | 730 | 395 | 780 | 400 | 243 |

All measurements in mm. Flanges according to EN 1092-2. Weights are approximations.