



Drain valve 357321

DESCRIPTION

Push button drain valve.

APPLICATION

Liquids that do not attack the integral material.

No.	Part	Material
1	Body	Bronze CC491K (RG5)
2	Stem	Special brass CW710R (SoMs59)
3	Compression spring	Tin bronze CW452K (CuSn6)
4	O-ring	NBR
5	Stop	Bronze CC491K (RG5)
6	Push button	Brass CW614N (Ms 58)

DN	Max. working pressure (bar)
	Up to 80°C
20-25	10

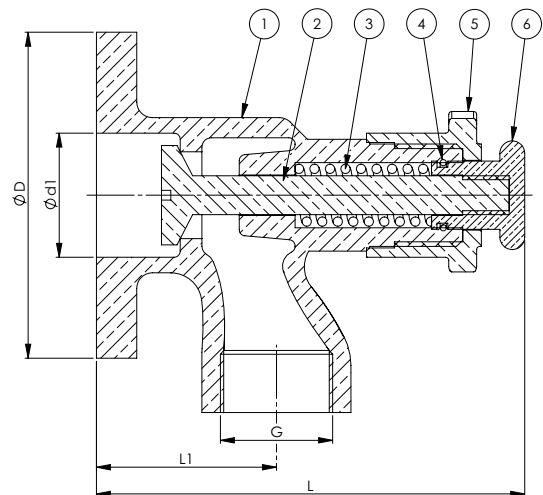

DN	Connection	Pressure rating	G (BSP)	L	L1	D	d1	Kg
20	PN 10	PN 10	1"	145	60	105	40	2,2
25	PN 10	PN 10	1"	145	60	115	40	2,4

All measurements in mm. Flanges according to EN 1092-3. Weights are approximations.